

FOUNDATION PLAN
A-3 SCALE 1/4"=1'-0"

EXPLANATION OF ALL NOTES:
1. ALL FOUNDATION WALLS TO BE CONCRETE ON GRADE.
2. ALL FOUNDATION WALLS TO BE 24" x 24" x 12" CONCRETE.
3. ALL FOUNDATION WALLS TO BE REINFORCED WITH #4 BARS @ 18" O.C.
4. ALL FOUNDATION WALLS TO BE FINISHED WITH 1/2" STEEL G.C. (TYP).
5. ALL FOUNDATION WALLS TO BE PROTECTED WITH 2" POLYSTYRENE INSULATION.
6. ALL FOUNDATION WALLS TO BE PROTECTED WITH 1/2" GYP BOARD.
7. ALL FOUNDATION WALLS TO BE PROTECTED WITH 1/2" GYP BOARD.
8. ALL FOUNDATION WALLS TO BE PROTECTED WITH 1/2" GYP BOARD.
9. ALL FOUNDATION WALLS TO BE PROTECTED WITH 1/2" GYP BOARD.
10. ALL FOUNDATION WALLS TO BE PROTECTED WITH 1/2" GYP BOARD.

STATISTICS:		D	©
AREA:	EXISTING:	PROPOSED:	
FIRST FLOOR AREA:	N/A	1,634 S.F.	
BONUS ROOM AREA:	N/A	394 S.F.	
TOTAL LIVING AREA:	N/A	1,634 S.F.	
BASEMENT AREA:	N/A	1,469 S.F.	
GARAGE AREA:	N/A	806 S.F.	
TOTAL AREA:	N/A	4,303 S.F.	

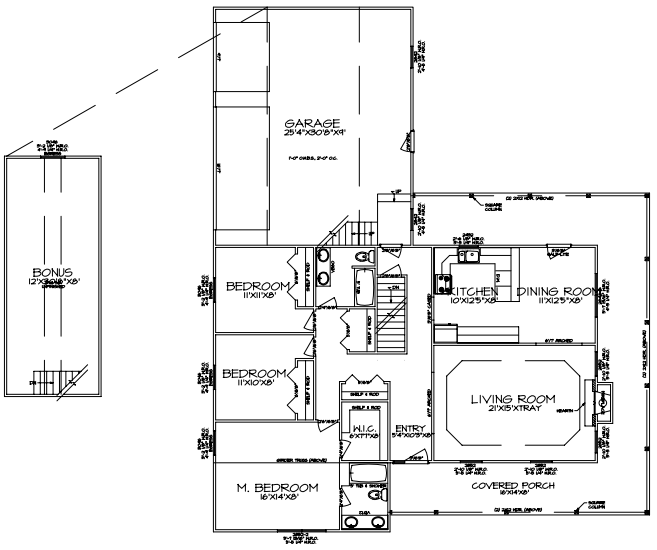

FIRST FLOOR PLAN
A-4 SCALE 1/4"=1'-0"

EXPLANATION OF ALL NOTES:
1. ALL FLOOR SLABS TO BE 4" THICK CONCRETE ON GRADE.
2. ALL FLOOR SLABS TO BE REINFORCED WITH #4 BARS @ 18" O.C.
3. ALL FLOOR SLABS TO BE FINISHED WITH 1/2" GYP BOARD.
4. ALL FLOOR SLABS TO BE PROTECTED WITH 2" POLYSTYRENE INSULATION.
5. ALL FLOOR SLABS TO BE PROTECTED WITH 1/2" GYP BOARD.
6. ALL FLOOR SLABS TO BE PROTECTED WITH 1/2" GYP BOARD.
7. ALL FLOOR SLABS TO BE PROTECTED WITH 1/2" GYP BOARD.
8. ALL FLOOR SLABS TO BE PROTECTED WITH 1/2" GYP BOARD.
9. ALL FLOOR SLABS TO BE PROTECTED WITH 1/2" GYP BOARD.
10. ALL FLOOR SLABS TO BE PROTECTED WITH 1/2" GYP BOARD.